

ZERO-X[®]



ZXM-G200

Zero-X 3 axis Gimbal with AI and Fill Light

USER MANUAL

CONTENTS

1.0	WHAT'S IN THE BOX.....	4
2.0	PRODUCT OVERVIEW	4
3.0	GETTING STARTED	5
4.0	ZX-G21 CONTROLS AND FUNCTIONS	7
4.1	POWER ON/OFF FUNCTION	7
4.2	OPERATION MODES	8
4.3	AI TRACKING MODULE	11
4.4	CHARGING.....	13
5.0	INSTALLING AND USING THE ZERO-X PIVOT APP	14
6.0	MANUAL STEPS FOR CONNECTING ZERO-X PIVOT APP	15
7.0	ZERO-X PIVOT APP MAIN USER SCREEN	16
8.0	SPECIFICATIONS	17
9.0	MAINTENANCE	18
10.0	WARRANTY	19
11.0	NOTES	25

1.0 WHAT'S IN THE BOX

- 1 x Zero-X 3 axis Gimbal with AI and Fill Light
- 1 x AI Module
- 1 x Mini Tripod Stand
- 1 x 50cm USB Charging Cable
- 1 x Lanyard
- 1 x Quick Start Guide
- 1 x User Manual

2.0 PRODUCT OVERVIEW

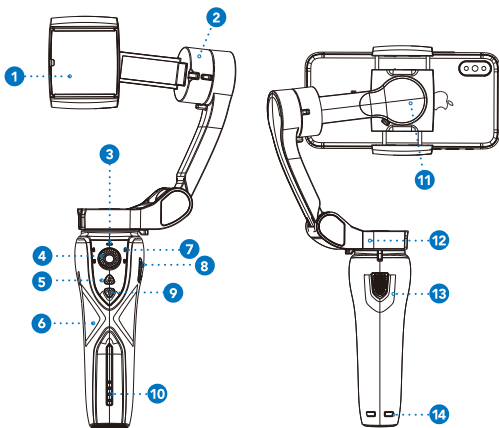

1. Smartphone Holder

2. Pitch Motor

3. Bluetooth Indicator

4. Joystick

5. Mode Button

6. Handle

7. Mode Indicator

8. Zoom Slider

9. Power Button

10. Battery Level Indicator

11. Roll Motor

12. Pan Motor

13. Trigger Button

14. Lanyard Mount

3.0 GETTING STARTED

Make sure your smartphone and 'ZXM-G200' are fully charged and you have the Zero-X Pivot App installed and running (see QR code on page 14).

1. Connect tripod to gimbal for easier handling.

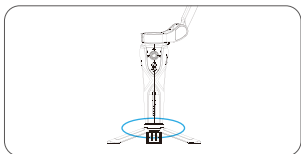

Attach tripod to the gimbal via the 1/4" thread screw port at the bottom of the handle. Unfold the gimbal, press and hold the power button for one second to power on.

2. It is recommended you remove any phone case before installing phone on the gimbal. Open Smartphone Holder and fit phone with screen towards you and the camera on the left-hand side. Ensure phone is centered in the holder. Adjust the phone's position so that it's balanced, and not tilting to any side.

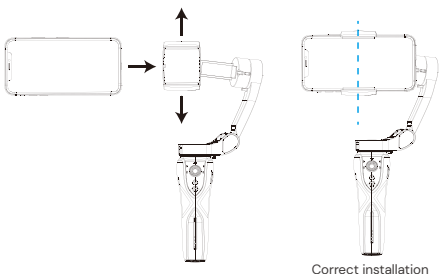

3. Connecting your phone with App.

- 1) Power On the ZXM-G200
- 2) Ensure Bluetooth is on your phone.
- 3) Click on Find Device.
- 4) ZXM-G200-XXXX will show on the Device lists.
- 5) Click on the ZXM-G200-XXXX

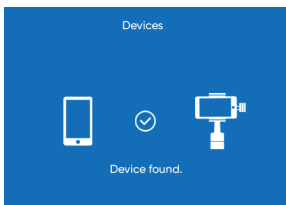

Devices List(1)

 ZXM-G200

FIND DEVICE

ENTER CAMERA



Home



Gallery



My App

4.0 ZX-G21 CONTROLS AND FUNCTIONS

4.1 POWER ON/OFF FUNCTION

Power On Controls

Single press: switch between horizontal & vertical mode/
Long press to power On/Off.

Fast Double press: switch between photo/video mode
(when Bluetooth is connected, you can control in App).

Fast triple press: switch camera between front/rear

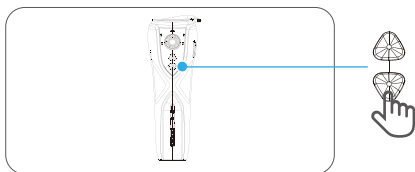

4.2 OPERATION MODES

There are four different working modes to choose from:

All Follow (AF): The Roll axis is locked. The Pan axis (left/right) and Tilt (up/down) will follow handle's movement. To enable this mode, short press the Mode Button to switch between different modes and stop when AF LED is On.

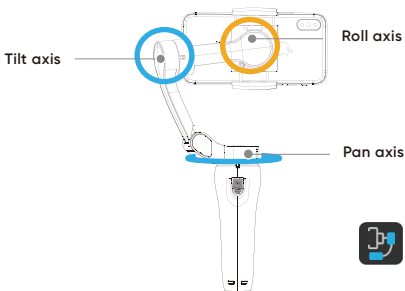

Half Follow (HF): Tilt axis and Roll axis are locked. Pan axis rotates (left/right) along with the handle movement. *Default mode when first powered on.

To enable this mode, short press the Mode Button to switch between different modes and stop when HF LED is On.

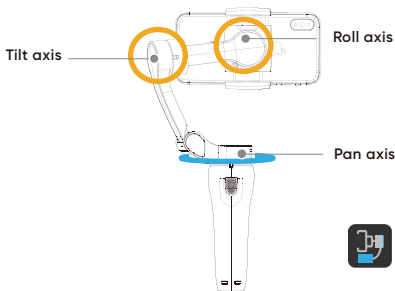

Lock Full (LF): Pan, Tilt, Roll axes are all locked. The camera remains still and stable, meaning it will not follow the movement of the handle.

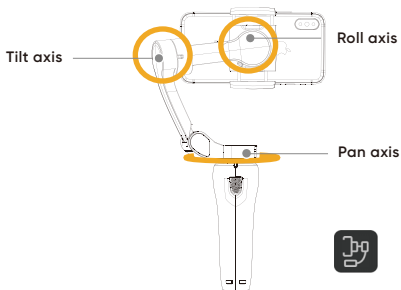

First Person View (FPV): Pan, Tilt, Roll axes follow the movement of the handle.

To enable this mode, short press the Mode Button to switch between different modes and stop when FPV LED is On.

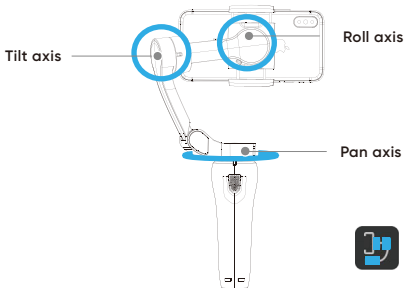

Reset

Press the Trigger and Power buttons at the same time to disconnect from previous phone or allow a new phone to connect.

Underslung Mode

Hold the gimbal upside down to enter Underslung Mode, letting you capture footage close to the ground.

Side-Grip Mode

Rotate gimbal right or left by 90° to go from upright to Side Grip Mode. Works with both Landscape and Portrait modes.

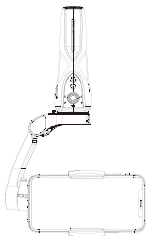

Underslung Mode:
Landscape Mode

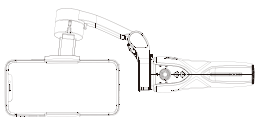

Side-Grip Mode: Landscape Mode

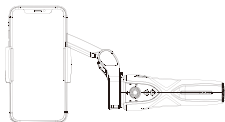

Side-Grip Mode: Portrait Mode

4.3 AI TRACKING MODULE

AI module helps you use most of the gimbal's features without downloading the app (accessing some features still requires use of the app).



Indicator 1 function:

Off: Gesture Recognition function is off

On: Gesture Recognition function is on

Flashing 3 times: Gesture Recognition function is activated and will respond as listed below

Flashing: Gimbal Bluetooth is connecting with AI Tracking Module

Gesture Control Prompts (after turning Gesture Function ON):

- ✌ Turn on Face Tracking
- ✋ Turn off Face Tracking
- ✎ Turn on/off the Fill Light
- ✎ Adjust the Fill Light mode and brightness



Indicator 2 function:

Off: Face Tracking function is off

Slow Flashing: Face Tracking function is on, but there's no face available for recognition

On: Face Tracking function is on and face is recognised

*Default status when connected with the gimbal: Gesture Recognition

function and Face Tracking function are both activated

Button 1 function:

Single press: turn on/off Gesture Recognition function

Double press: turn on/off Face Tracking function

Button 2 function:

Press and hold: turn on/off the LED light

Single press: change the Light Mode and light levels (9 levels)

Light Mode:

Mixed Light: soft, mid, strong

Warm Light: soft, mid, strong

White Light: soft, mid, strong

4.4 CHARGING

This unit supports fast charging. A 5V/2A adaptor is recommended for charging the gimbal.

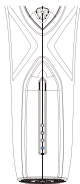
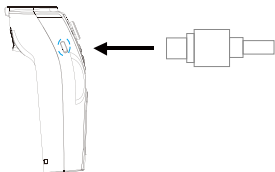

Charging

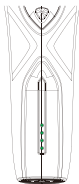

Charging completed

5.0 INSTALLING AND USING THE ZERO-X PIVOT APP

Please scan the below QR code:

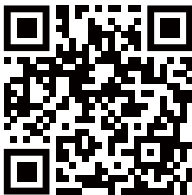

Supports iOS and Android

Or please search the App Store/Play Store for 'Zero-X Pivot'.

THE Zero-X Pivot App requires iOS 12.0 and above on iPhone, or Android 8.0 and above on your device to run.

Note: This product links with your smartphone's camera, and can support basic stable shooting without using the App. For more functions (such as panoramic, zoom, tracking and time lapse), you need to download and use the App.

6.0 MANUAL STEPS FOR CONNECTING TO ZERO-X PIVOT APP

1. Turn on your phone and scan the QR code or search relevant App store for Zero-X Pivot, and download the App.
2. Turn on Bluetooth on your phone and open the Zero-X Pivot App. Connect to the device called 'ZXM-G200-XXXX'. Once opened, the App should prompt you to connect to Bluetooth.
3. After Bluetooth is connected successfully, you can control the smartphone camera and gimbal from the App.

7.0 ZERO-X PIVOT APP MAIN CONTROL SCREEN

Android App

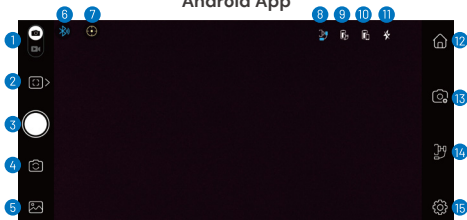

- | | |
|--------------------------------|---------------------------------|
| 1. Video/Photo Mode | 9. Gimbal Battery Power Display |
| 2. Shooting Function Selection | 10. Phone Battery Power Display |
| 3. Shoot Button | 11. Flash |
| 4. Front/Rear Camera Switch | 12. Home Page |
| 5. Album | 13. Camera Parameters |
| 6. Bluetooth Connection Status | 14. Gimbal Mode Adjustment |
| 7. Face/Object Tracking | 15. Settings |
| 8. Gimbal Position Display | |

iOS App

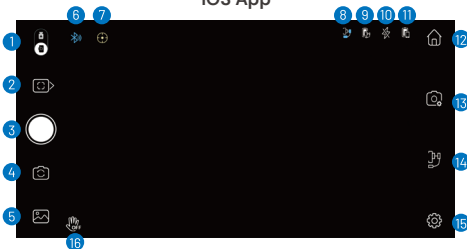

- | | |
|--------------------------------|-------------------------|
| 1. Video/Photo Mode | 9. Gimbal Power Display |
| 2. Shooting Function Selection | 10. Phone Power Display |
| 3. Shoot Button | 11. Flash |
| 4. Front/Rear Camera Switch | 12. Home Page |
| 5. Album | 13. Camera Parameters |
| 6. Bluetooth Connection Status | 14. Gimbal Mode Adjust |
| 7. Face/Object Tracking | 15. Settings |
| 8. Gimbal Position Display | 16. Gesture Control |

8.0 SPECIFICATIONS

Specification	Gimbal
Model	ZXM-G200
Dimensions	Folded: 152 x 110 x 46.6mm Unfolded: 260 x 130 x 88mm
Weight	360g
Compatible Phone Size	1. Diagonal: $\leq 180\text{mm}$ 2. Width: 55-90mm 3. Thickness: $\leq 9.5\text{mm}$
Maximum Payload	280g
Input	5V d.c. 2A
Battery Capacity	2550mAh
Operation Time	5 Hours
Charging Time	1.5 Hours (using 5V2A adapter)
Tile Angle	160°
Pan Angle	340°
Face Tracking	Yes
App Control	Yes

9.0 MAINTENANCE

Caution

1. Ensure the motor's rotation is not blocked by external forces during and after the stabiliser being powered on;
2. Please do not contact the unit with sea water or corrosive liquid;
3. Please do not disassemble the stabiliser (except for the detachable accessories covered in the manual);
4. If the motor works continuously for a long time, its surface temperature may grow hot. It's suggested unit is turned off to allow for cooling.
5. Do not drop or collide with the stabiliser, this will cause abnormal operation.

Storage and maintenance

1. Please keep this product away from children and pets;
2. Do not put the product near heat sources (furnaces, heaters etc.) or in cars in hot weather.
3. Please store the product in a dry environment;
4. Do not overcharge or over discharge the battery, otherwise the battery cell could be damaged;
5. Do not use the product in environments with extreme high or low temperatures.

10.0 WARRANTY

WARRANTY TERMS & CONDITIONS

Our goods come with guarantees that cannot be excluded under the Australian Consumer Law. You are entitled to a replacement or refund for a major failure and for compensation for any other reasonably foreseeable loss or damage. You are also entitled to have the goods repaired or replaced if the goods fail to be of acceptable quality and the failure does not amount to a major failure.

This warranty is provided in addition to your rights under the Australian Consumer Law. Directed Electronics Australia Pty Ltd (Directed Electronics) warrants that this product is free from defects in material and workmanship for a period of 12 months from the date of purchase or for the period stated on the packaging. This warranty is only valid where you have used the product in accordance with any recommendations or instructions provided by Directed Electronics.

This warranty excludes defects resulting from alterations of the product, accident, misuse, abuse or neglect. In order to claim the warranty, you must return the product to the retailer from which it was purchased or if that retailer is part of a National network, a store within that chain, along with satisfactory proof of purchase. The retailer will then return the goods to Directed Electronics.

Directed Electronics will repair, replace or refurbish the product at its discretion. The retailer will contact you when the product is ready for collection. All costs involved in claiming this warranty, including the cost of the retailer sending the product to Directed Electronics, will be borne by you.

Email: admin@zero-x.com.au

INDEMNITY

You agree to defend, indemnify and hold harmless Zero-X and its subsidiaries and affiliates from and against any and all claims, proceedings, injuries, liabilities, losses, costs and expenses (including reasonable legal fees), including but not limited to, claims alleging negligence, invasion of privacy, copyright infringement and/or trademark infringement against Zero-X and its subsidiaries and affiliates, relating to or arising out of your breach of any provision of these terms, your misuse of Zero-X or its services, or your unauthorized modification or alteration of products or software.

WARRANTY AND WARRANTY DISCLAIMER

Zero-X has a limited warranty, whereby Zero-X warrants to you and only to you that this Zero-X Gimbal will be free from defects in materials and workmanship for one (1) year from the date of your purchase (unless a longer warranty period is required by law). The specifics of this Zero-X limited warranty are covered in this manual.

To the extent possible under governing law, other than the above product warranty for the Zero-X Gimbal you understand and agree that the Zero-X services are provided on an “as is” and “as available” basis.

Zero-X makes no warranty that the Zero-X product and services will meet your requirements or that use of the Zero-X services will be uninterrupted, timely, secure or error-free. Nor does Zero-X make any warranty as to the accuracy or reliability of any information obtained through the Zero-X (including third party content), that any defects in the Zero-X will be corrected or that the Zero-X products or Zero-X services will be compatible with any other specific hardware or service. Further, Zero-X does not warrant that the Zero-X or the Zero-X servers that provide you with data and content are free of viruses or other harmful components.

Zero-X also assumes no responsibility for and shall not be liable, for any damages caused by viruses that may infect your Zero-X.

In the event of any loss, damage or injury, you will not look to Zero-X to compensate you or anyone else. You release and waive for yourself and your insurer all subrogation and other rights to recover against Zero-X arising as a result of the payment of any claim for loss, damage or injury.

Zero-X equipment and services do not cause and cannot eliminate occurrences of certain events, including, and Zero-X makes no guarantee or warranty, including any implied warranty of merchantability or fitness for a particular purpose, that the Zero-X equipment and services provided will detect or avert such incidents or their consequences.

Zero-X does not undertake any risk that you or property, or the person or property of others, may be subject to injury or loss if such an event occurs. The allocation of such risk remains with you, not Zero-X.

Other than the above product warranty for the Zero-X, its suppliers disclaim all warranties of any kind, whether express, implied, or statutory, regarding the Zero-X services, including any implied warranty of title, merchantability, fitness for a particular purpose, or noninfringement of third party rights.

Because some jurisdictions do not permit the exclusion of implied warranties, the last sentence of this section may not apply to you. Zero-X hereby further expressly disclaims all liability for any claims for service failures that are due to normal product wear, product misuse, abuse, product modification, improper product selection or your non-compliance with all applicable federal, state or local laws.

This warranty and warranty disclaimer give you specific legal rights, and you may have other rights that vary by state, province, or country. Other than as permitted by law, Zero-X does not exclude, limit or suspend other rights you have, including those that may arise from the nonconformity of a sales contract.

For a full understanding of your rights, you should consult the laws of your state, province, or country. For our Australian customers: Please note that this warranty is in addition to any statutory rights in Australia in relation to your goods which, pursuant to the Australian Consumer Law, cannot be excluded.

LIMITATIONS OF ZERO-X LIABILITY

Under no circumstances will Zero-X be liable in any way for any content, including, but not limited to, the loss of content, any errors or omissions in any content, or any loss or damage of any kind incurred in connection with use of or exposure to any content posted, emailed, accessed, transmitted, or otherwise made available via Zero-X.

Zero-X liability for damages, especially for breach of duty or obligation, delay in performance, non-performance, or malperformance shall be precluded, except when these are due to negligent breaches of any significant contractual duty or obligation on the part of Zero-X. Any liability for negligence is limited to direct losses usually and typically foreseeable in such case. Should the claim for damages be based on wilful or grossly negligent breach of contractual duty or obligation on the part of Zero-X, the preclusion and limitation of liability mentioned in the preceding sentences will not apply. The preceding preclusion and limitation of liability will also not apply to claims for damages arising out of loss of life, bodily injury or health impacts for which Zero-X may be liable, or for non-contractual liability.

Some states and countries do not allow the exclusion or limitation of incidental or consequential damages, so the above limitation or exclusion may not apply to you. Additionally, this provision is not intended to limit Zero-X's liability in the event of Zero-X's wilful or intentional misconduct.

Capture the action.™



www.zero-x.com.au
www.zero-x.co.nz

All Images, Information and Content are
Copyright © 2024 Directed Electronics
Australia Pty Ltd. All Rights Reserved.